



RAMPA®

Good idea. Let's make it!

CHIPBOARD

Strong connections for Chipboard



Strong in every area, such as:

- Furniture construction
- Stair construction
- Timber construction
- Millwork

RAMPA®-inserts
Type: SKD330



&

RAMPA®-inserts
Type: SK330



- Wide range of applications
- Automatic alignment by 3 support points
- Guaranteed straight assembling
- Hub for simplified assembling
- Up to 2.5 times faster than conventional inserts
- Maximum load capacity utilization of the assembling area
- Patented 3-start thread contour

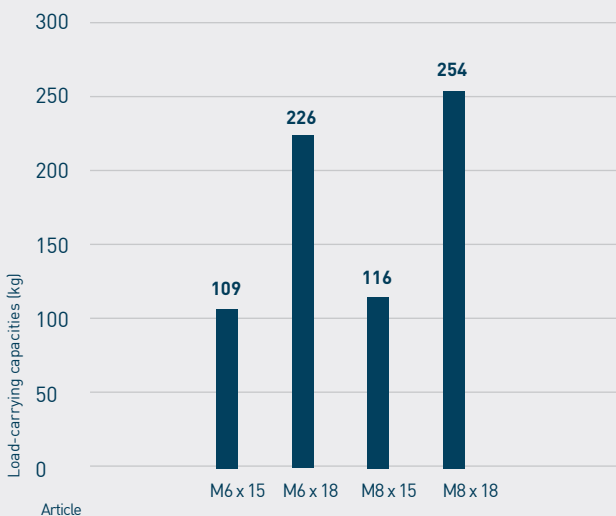

RAMPA®-inserts
Type: SKD30



- Wide range of applications
- Hub for simplified assembling
- High load capacity utilization of the assembling area
- Patented 1-start thread contour

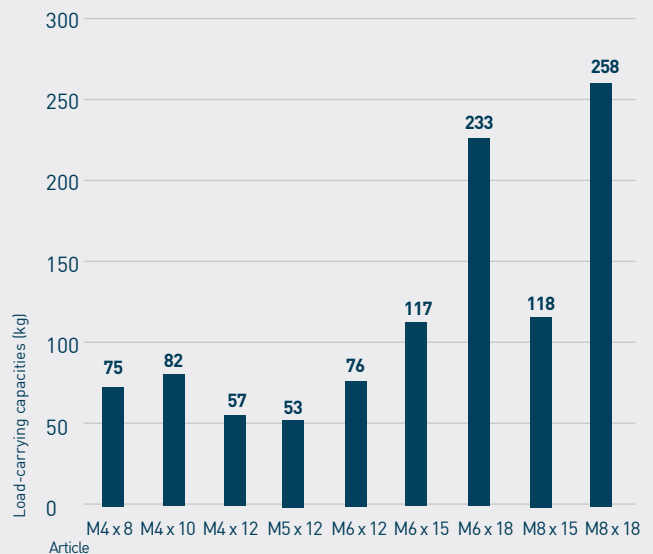

* The reference load-carrying capacities mentioned before might vary in individual cases due to different mechanical properties depending on the material used.



RAMPA®

Good idea. Let's make it!

CHIPBOARD

The suitable inserts for Chipboard

RAMPA®-inserts | Type: SKD330

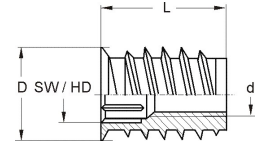

Chipboard Panel Thickness (mm)	Art. No.	Outer-Ø D (mm)	Length L (mm)	Thread size d (mm)	Hex size SW	Pre-drill Ø (mm)	Assembling Torque (Nm)	Steel Zinc Plated
18	420615001	12	15	M6	6	10	4	✓
18	420855001	14	15	M8	8	12	7	✓
22	420618001	12	18	M6	6	10	3,75	✓
22	420858001	14	18	M8	8	12	10	✓
25	420120001	18,5	20	M10	10	16,5	X	✓
30	420125001	18,5	25	M10	10	16,5	X	✓

UNC sizes available

RAMPA®-inserts | Type: SK330

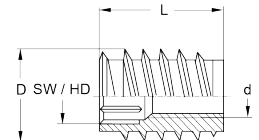

Chipboard Panel Thickness (mm)	Art. No.	Outer-Ø D (mm)	Length L (mm)	Thread size d (mm)	Hex size SW	Pre-drill Ø (mm)	Assembling Torque (Nm)	Steel Zinc Plated
18	040615001	12	15	M6	6	10	4	✓
18	040855001	14	15	M8	8	12	7	✓
22	040618001	12	18	M6	6	10	3,75	✓
22	040858001	14	18	M8	8	12	10	✓
24	040620001	12	20	M6	6	10	X	✓
25	04012007	18,5	20	M10	10	16,5	X	
35	040830001	16	30	M8	8	14	X	✓

UNC sizes available

*1 We hereby inform you according to Article 33 - REACH, that this article contains the following substance identified as SVHC:
Lead (Pb); CAS: 7439-92-1 Date of Admission: 27.06.2018

RAMPA GmbH & Co. KG

Auf der Heide 8 | 21514 Büchen | Germany | Phone +49 (0) 4155 8141-601 | wood@rampa.com | www.rampa.com



CHIPBOARD

RAMPA®

Good idea. Let's make it!

The suitable inserts for Chipboard

RAMPA®-inserts | Type: SKD30

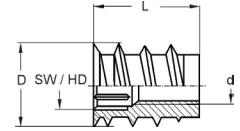

Chipboard Panel Thickness (mm)	Art. No.	Outer-Ø D (mm)	Length L (mm)	Thread size d (mm)	Hex size SW	Pre-drill Ø (mm)	Assembling Torque (Nm)	Steel Zinc Plated
12	439408001	8	8	M4	4	7	X	✓
16	439410001	8	10	M4	4	7	X	✓
18	439615001	12	15	M6	6	10	3,5	✓
18	439855001	14	15	M8	8	12	6	✓
22	439618001	12	18	M6	6	10	3,75	✓
22	439858001	14	18	M8	8	12	11	✓

UNC sizes available



RAMPA®

Good idea. Let's make it!

CHIPBOARD

Recommended RAMPA® assembling tools:

Driver | Type 515
Round or hexagonal shank



Driver | Type 504
Shank DIN 3126 E11.2



Driver | Type 506
Shank DIN 3126 E6.3



Suitable RAMPA® connecting materials:

Flat-head screws | Type KF



Pan-head screws | Type KC



Pan-head screws | Type KS



Mushroom-head screws | Type KT



Pan-head screws | Type SG



Pan-head screws | Type KFTX

