

# RAMPA®

Good idea. Let's make it!

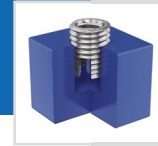

## Approved 1-click RAMPA® **Lifting System**

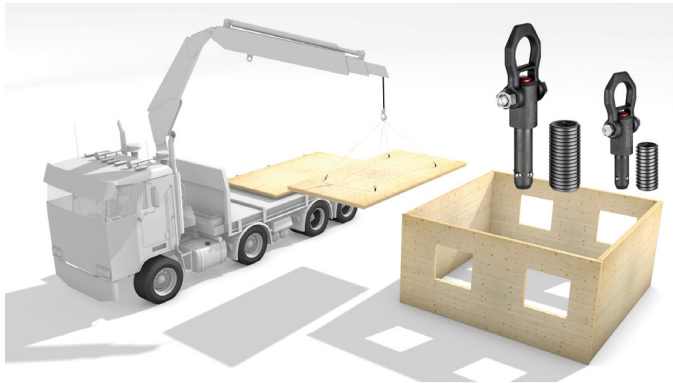

Clicking on the image takes you to the [video](#).

Easy, safe and secure. Ideal for:

- ✓ Cross laminated timber
- ✓ Glue laminated timber
- ✓ Construction timber

RAMPA® Lifting System consisting of:  
**Load suspension type X and insert type X**

- ⇒ Safe and fast lifting for loads up to 3.6 tons
- ⇒ 1-click self-locking system
- ⇒ Simple and fast connection
- ⇒ Maintenance-free, visual functional check sufficient
- ⇒ Constant load capacity even in wet timber conditions
- ⇒ Self-adjusting shackle
- ⇒ Easy installation of timber walls
- ⇒ RAMPA® drills and sockets in stock

## Load data

Transport via the lateral surface (in kg)

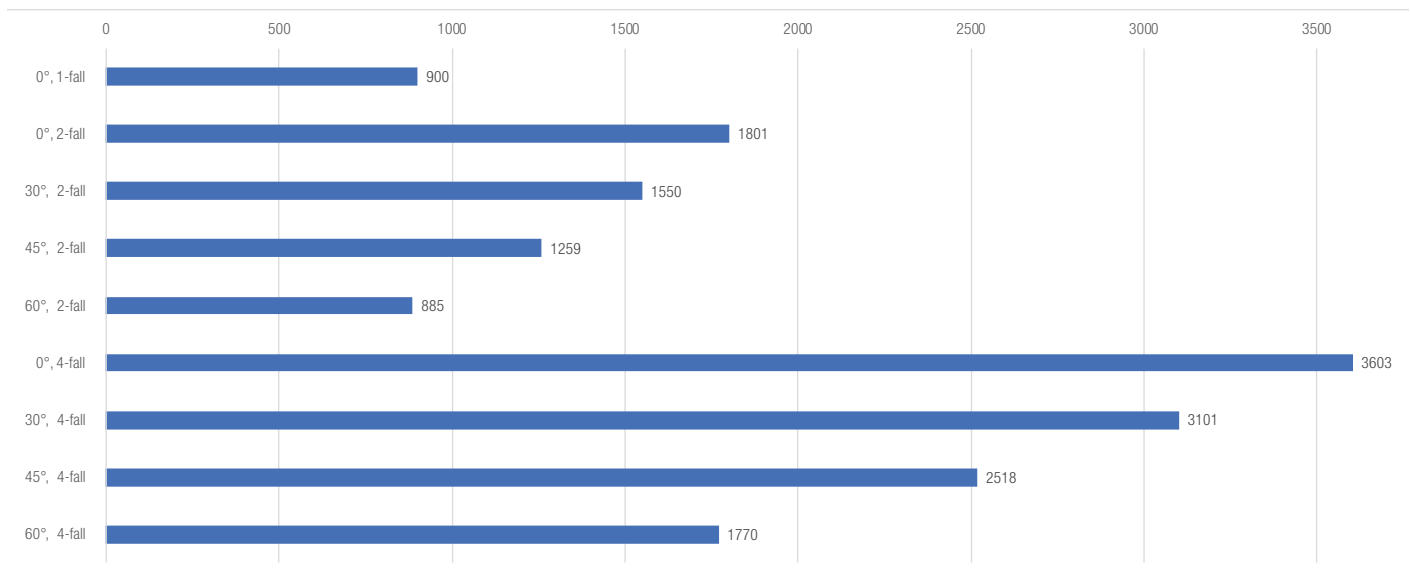

Values apply to insert type X (36 x 70 mm)



## Approved 1-click RAMPA® Lifting System

### Installation of timber construction elements (in kg)

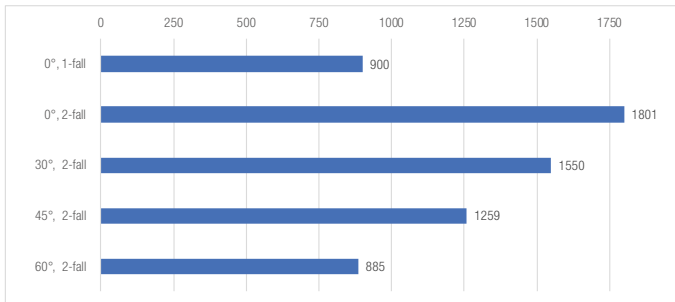

Values apply to insert type X (36 x 70 mm)

### Transport via the narrow side (in kg)

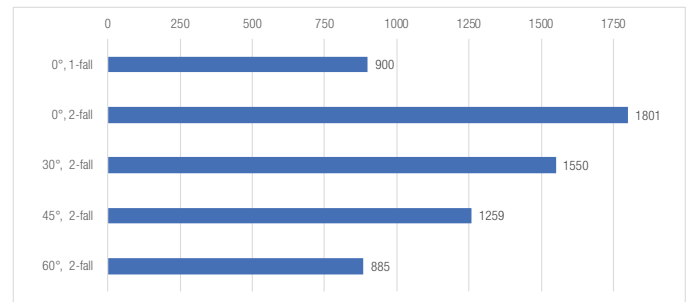

Values apply to insert type X (36 x 70 mm)

Thickness of cross-laminated board  $d \geq 62.5$  mm (insert 25 x 50 mm) or  $d \geq 120$  mm (insert 36 x 70 mm); angle between axial direction and grain direction  $\epsilon = 90^\circ$ . Additional requirements must be observed during use. Please see document [Load Data RAMPA® Lifting System](#) for further information. The load data is calculated for an oscillation coefficient  $\Phi$  of 1.30. This applies to the following lifting system: stationary crane, slewing crane, rail crane, lifting speed  $> 90$  m/min

Note: If means of transport are unknown, the oscillation coefficient "Lifting and transport in uneven terrain"  $\Phi = 2.00$  must be used.

## RAMPA® Lifting System

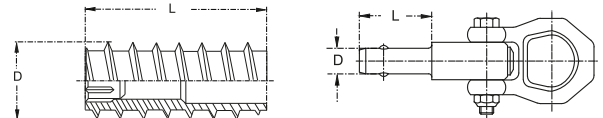

Description	Outer diameter D (in mm)	Length L (in mm)	Hex size HS	Pilot hole (in mm)	Item No.	Material steel
Insert type X, steel hardened	25	50	16	23	610101	•
Load suspension type X (suitable for 25 x 50 mm)	16	25	—	—	610102	•
Insert type X, steel hardened	36	70	20	34	610201	•
Load suspension type X (suitable for 36 x 70 mm)	20	50	—	—	610202	•

## Recommended driving tools

**RAMPA® socket type X**  
HD16, 1/2" drive, for impact use

Item No.: 610103

**RAMPA® socket type X**  
HD20, 1/2" drive, for impact use

Item No.: 610203

## Recommended drills

**RAMPA® drill type X** (ø 23 mm)  
Carbon steel, ideal pre-drill diameter

Item No.: 610 104

**RAMPA® drill type X** (ø 34 mm)  
Carbon steel, ideal pre-drill diameter

Item No.: 610 204